

S = 1 : 500

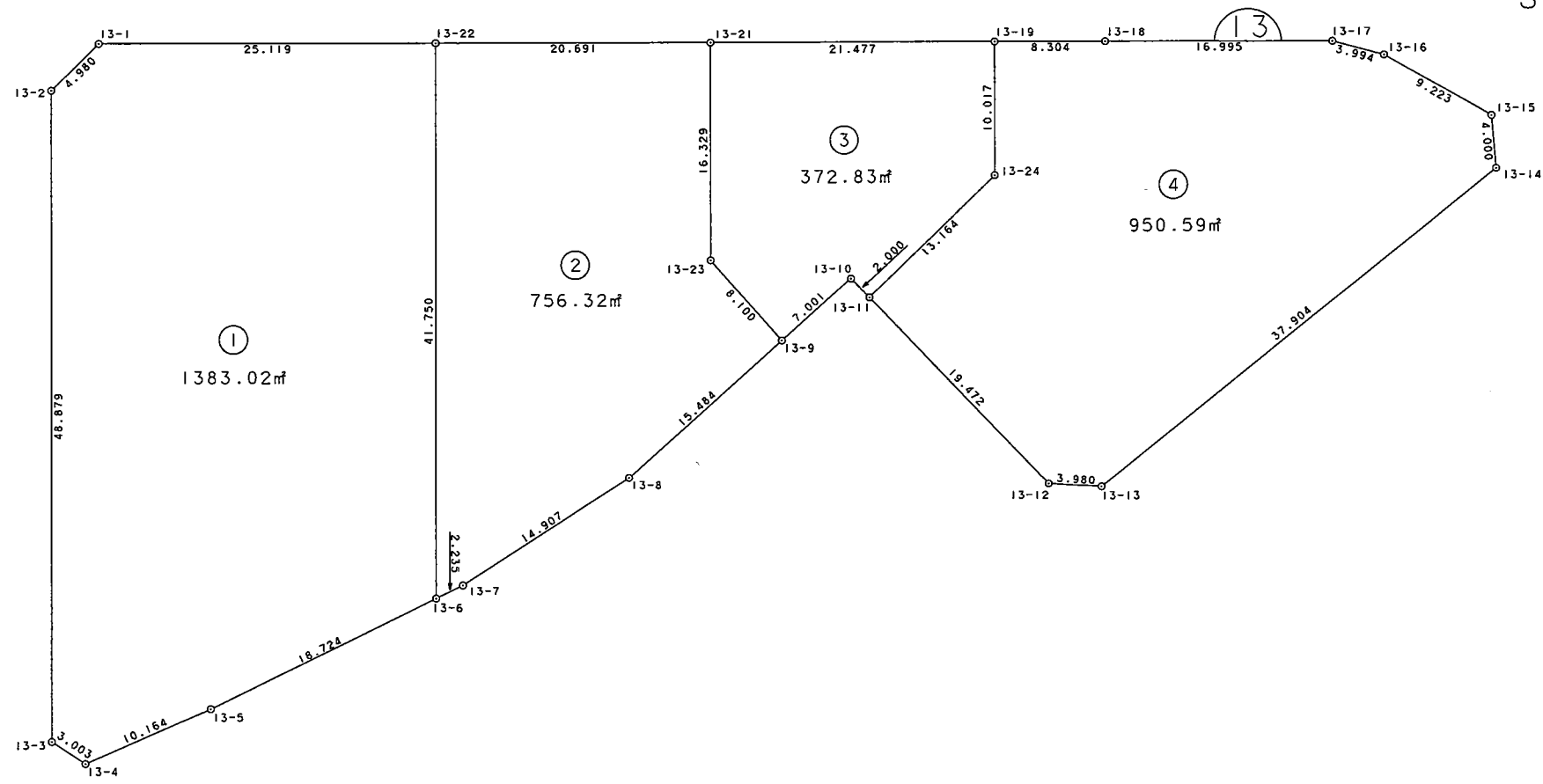

面積 (座標法) 計算書

地番 = 13B1
測点名

	[1] X(i)	[2] X(i+1)-X(i-1)	[3] Y(i)	[4] Y(i+1)-Y(i-1)	[2]*[3]	[1]*[4]	方向角	夾角	距離
13-1	35943.425	11.263	-36752.365	-26.562	-413941.886995	-954729.254850	254-54-52	134-54-57	4.980
13-2	35942.129	-43.622	-36757.173	-29.255	1603421.400606	-1051486.983895	210-00-37	135-05-45	48.879
13-3	35899.803	-45.011	-36781.620	-23.101	1655577.497820	-829321.349103	153-22-31	123-21-54	3.003
13-4	35897.118	-3.818	-36780.274	11.447	140427.086132	410914.309746	96-24-00	123-01-29	10.164
13-5	35895.985	-2.405	-36770.173	28.782	88432.266065	1033158.240270	93-53-43	177-29-43	18.724
13-6	35894.713	34.881	-36751.492	39.562	-1281928.792452	1420066.635706	30-00-34	116-06-51	41.750
13-22	35930.866	48.712	-36730.611	-0.873	-1789221.523032	-31367.646018	299-59-55	89-59-21	25.119
合計					倍面積 2766.048144	-2766.048144			152.619
					面積 1383.0240720	1383.0240720			
					坪數 418.36	418.36			

面積 (座標法) 計算書

地番 = 13B2
測点名

	[1] X(i)	[2] X(i+1)-X(i-1)	[3] Y(i)	[4] Y(i+1)-Y(i-1)	[2]*[3]	[1]*[4]	方向角	夾角	距離
13-22	35930.866	-25.809	-36730.611	-38.801	947980.339299	-1394153.531666	210-00-34	90-00-52	41.750
13-6	35894.713	-36.305	-36751.492	-18.651	1334262.917060	-669472.292163	93-53-58	63-53-24	2.235
13-7	35894.561	0.593	-36749.262	17.118	-21792.312366	614443.095198	87-08-07	173-14-09	14.907
13-8	35895.306	3.890	-36734.374	30.049	-142896.714860	1078618.049994	78-16-51	171-08-44	15.484
13-9	35898.451	11.076	-36719.213	13.516	-406702.003188	485203.463716	348-16-56	90-00-05	8.100
13-23	35906.382	22.071	-36720.858	6.522	-810466.056918	234181.423404	30-00-36	221-43-40	16.329
13-21	35920.522	24.484	-36712.691	-9.753	-898873.526444	-350332.851066	299-59-42	89-59-06	20.691
合計				倍面積	1512.642583	-1512.642583			119.496
				面積	756.3212915	756.3212915			
				坪數	228.78	228.78			

面積 (座標法) 計算書

地番 = 13B3
測点名

	[1] X(i)	[2] X(i+1)-X(i-1)	[3] Y(i)	[4] Y(i+1)-Y(i-1)	[2]*[3]	[1]*[4]	方向角	夾角	距離
13-21	35920.522	-3.403	-36712.691	-26.767	124933.287473	-961484.612374	210-00-36	90-00-50	16.329
13-23	35906.382	-22.071	-36720.858	-6.522	810466.056918	-234181.423404	168-16-56	138-16-20	8.100
13-9	35898.451	-6.509	-36719.213	8.500	239005.357417	305136.833500	78-16-51	89-59-55	7.001
13-10	35899.873	-0.519	-36712.358	7.338	19053.713802	263433.268074	166-01-35	267-44-44	2.000
13-11	35897.932	1.238	-36711.875	13.257	-45449.301250	475898.884524	76-01-30	89-59-55	13.164
13-24	35901.111	11.853	-36699.101	17.784	-434994.444153	638465.358024	30-00-37	133-59-07	10.017
13-19	35909.785	19.411	-36694.091	-13.590	-712269.000401	-488013.978150	299-59-46	89-59-09	21.477
合計				倍面積	745.669806	-745.669806			78.088
				面積	372.8349030	372.8349030			
				坪數	112.78	112.78			

面積（座標法）計算書

地番 = 13B4
測点名

	[1] X(i)	[2] X(i+1)-X(i-1)	[3] Y(i)	[4] Y(i+1)-Y(i-1)	[2]*[3]	[1]*[4]	方向角	夾角	距離
13-19	35909.785	-4.522	-36694.091	-12.202	165930.679502	-438171.196570	210-00-37	90-00-44	10.017
13-24	35901.111	-11.853	-36699.101	-17.784	434994.444153	-638465.358024	256-01-30	226-00-53	13.164
13-11	35897.932	-22.075	-36711.875	-8.072	810414.640625	-289768.107104	166-01-36	90-00-06	19.472
13-12	35879.036	-21.090	-36707.173	8.023	774154.278570	287857.505828	123-27-02	137-25-26	3.980
13-13	35876.842	3.684	-36703.852	40.766	-135216.990768	1462555.340972	81-04-43	137-37-41	37.904
13-14	35882.720	9.499	-36666.407	39.145	-348294.200093	1404629.074400	25-08-57	124-04-14	4.000
13-15	35886.341	11.586	-36664.707	-2.950	-424797.295302	-105864.705950	329-43-24	124-34-27	9.223
13-16	35894.306	10.783	-36669.357	-7.480	-395405.676531	-268489.408880	314-52-42	165-09-18	3.994
13-17	35897.124	11.327	-36672.187	-17.542	-415385.862149	-629707.349208	300-02-38	165-09-56	16.995
13-18	35905.633	12.661	-36686.899	-21.904	-464492.828239	-786476.985232	299-59-53	179-57-15	8.304
合計				倍面積	1901.189768	-1901.189768			127.053
				面積	950.5948840	950.5948840			
				坪數	287.55	287.55			