

How to Properly Separate and Dispose of Household Trash – FY2024 Edition



separating and trashing

Recyclable Trash

Rinse inside well to remove any waste, and place trash in their respective specified baskets/nets according to the symbol marked on each item.
***Do not dispose of any items that are dirty or have residual matter as recyclable trash. Please check the rules for separation and disposal of recyclables.**

PET Bottles



*Clear pet bottles for food *Community ("Gyosei") Centers and Lifelong Learning Centers also collect plastic for recycling (excluding Ojima Community Center).

- PET bottles without a mark, colored bottles, and dirty bottles should be placed as "Burnable trash."
- Dispose of caps and labels as "Containers and Wrapping."
- Please crush and make them as small as possible.

Disposal Method

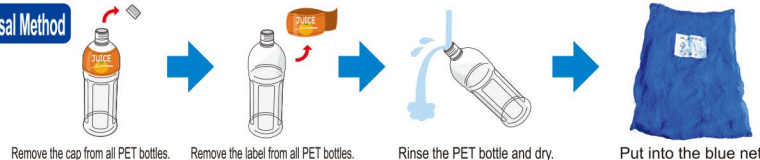

Containers and Wrapping (Other Plastics)



*Community ("Gyosei") Centers and Lifelong Learning Centers also collect plastic for recycling (excluding Ojima Community Center).

[Notice] Remove plastic containers from the plastic bag and put them into the green net!!

- Dispose of dirty bottles or ones without the ♻️ mark as "Burnable Trash."
- Only containers, wrapping, or packaging with the ♻️ mark.
- Ex.: Food containers, colored Styrofoam trays, take-out lunch containers, egg/tofu packages, supermarket shopping bags, shampoo/cleaning agent bottles, PET bottle caps and labels, medicine containers, cushioning materials (made of Styrofoam), etc.

Disposal Method



Cans



*Food Cans Round, cylindrical cans (*Cans up to 20x15cm)

- Dispose of cans that are square-shaped, are dirty, have lingering oil residue, are rusty, or are burnt as "Non-Burnable trash."

Disposal Method

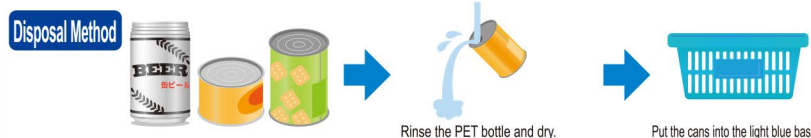

Glass Bottles & Jars

*Food and Cosmetic and Medicine bottles When disposing, remove the cap and separate into the colors shown below:

- Dispose of caps, broken bottles and dirty bottles as "Non-Burnable trash."

Disposal Method



Milk Cartons



*Paper cartons with a white inside.

- Dispose of paper cartons which are hard to remove dirt and oil, and whose insides are aluminum-lined as "Burnable trash."

Disposal Method

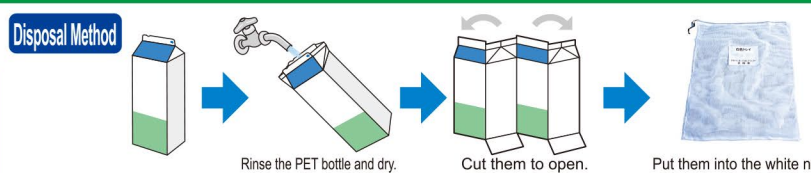

White Styrofoam Trays



*All white Styrofoam trays for food (The trays which get stuck with a toothpick)

- Dispose of colored or patterned trays, or white trays that are coated to be glossy as "Containers and Wrapping (Other plastics)."
- Take off the wrap and tape before disposal.

Disposal Method

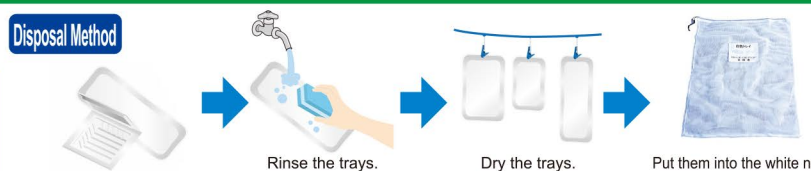

Garbage trucks may not always come at the same time due to weather/road conditions and the amount of trash. Please put out your garbage on the designated date and location by 8:30 a.m. *Do not put out trash the day prior to collection days

Burnable Trash

Caution

- Use designated trash bags. Trash placed in supermarket/other/other bags will not be picked up.
- Never put in glass shards or metal scraps.
- Please empty the containers before disposal.
- Get rid of as much water as possible from your food waste.
- For beanbags, ask for door-to-door collection or take them directly to the center.

Disposable Items

- Kitchen garbage (drain water from garbage well)
- Wood waste including branches (remove roots), weeds (remove soil), and bamboo
- Leather and rubber products
- Old fabric products, disposable diapers (remove human waste first)
- Plastic products (e.g. buckets, planters, hangers, etc.)

Disposal Method

- Make sure to tie up the opening of the bag so that its contents do not come out.
- When disposing of pruned branches, cut them to a size no larger than 60cm long and 10cm in diameter and put them into a designated trash bag, or tie them into a bundle up to 50cm in diameter and place them in a 45L bag.
- The amount of trash allowed to be disposed of at one time is two 45L trash bags.

Specified Trash Bags



Prices of Specified Trash Bags

Size	Quantity	Price
L 45ℓ	10 bags	¥200
M 30ℓ	14 bags	¥150
S 20ℓ	20 bags	¥150

Non-Burnable Trash

Caution

- Use designated trash bags. Trash placed in supermarket/otherbags will not be picked up.
- Dispose of spray cans, lighters, portable gas burner fuel cans, batteries (including re-chargeable batteries), electronic cigarettes, electric razors, etc. as hazardous trash.
- If you cannot remove the re-chargeable batteries, take them directly to the facility (direct carry-in) or dispose of them into a Small Home Appliance Recycling collection box. (It can lead to facilities and garbage trucks catching on fire.)

Disposable Items

- Glass objects, porcelain, metal objects (pots, frying pans, etc.), razors
- Umbrellas only, even if they come out of the bag, will be collected.
- Broken glass and cans unsuitable for recycling
- Household appliances that fit into designated trash bags (e.g., rice cookers, electric pots, etc.) *Items subject to the Home Appliance Recycling Law, and PCs are not accepted (see reverse side) (Please make sure to take batteries (including re-chargeable ones) out when disposing.)

Disposal Method

- Wrap glass products and knives in paper, cloth, etc. before disposing.
- The amount of trash allowed to be disposed of at one time is up about two 30L trash bags.

Specified Trash Bags



Prices of Specified Trash Bags

Size	Quantity	Price
30ℓ	10 bags	¥400
15ℓ	10 bags	¥200

Oversized Trash

Caution

- Trash that is too large to fit into the city's specified trash bags is considered oversized trash.
- Please take dissolved garbage directly to the center.
- For beanbags, ask for door-to-door collection or take them directly to the center.

Disposable Items/Fees

- For disposal fees, please refer to the "Matters Concerning Oversized Trash."
- *Please contact the Cleaning and Disposal Service Division ("Seiso Jigyo-Ka") regarding items not listed.

Disposal Method

1. Trash disposal station → Affix an "Oversized Trash Disposal Sticker" and put it out for collection.
2. Door-to-door collection → Apply in advance to the Cleaning and Disposal Service Division "Seiso Jigyo-Ka", (TEL: 0276-31-8153) (reservations necessary)
3. Direct carry-in → Carry directly into Recycle Plaza (see reverse side). (Direct carry-in costs: ¥130 per 10kg for household trash. Oversized Trash Disposal Stickers are not required.)

Oversized Trash Disposal Sticker



*Oversized Trash Disposal Stickers are sold at stores that sell Ota City specified trash bags. Please check at store registers or information centers.
*Cannot be returned or exchanged.

Hazardous Trash

Disposal Method

Don't open a hole in spray cans and butane gas cartridges for danger.

Dispose of items in designated baskets!



Spray Cans / Lighters / Portable Gas Burner Fuel Cans

Use up gas in spray cans and butane gas cartridges for prevention of danger in garbage collection and fire of the facility.
*Please consult Cleaning Business="Seiso Jigyo-Ka" about difficulty in using up the gas.

Fluorescent tubes, light bulbs, LED lights, mercury thermometers, mercury blood pressure meters

For safety, remove fluorescent tubes and lightbulbs from the device and place in its original box or wrap in paper before disposing. Place broken items in plastic bags, etc.

Batteries (incl. re-chargeable and button)

- As a general rule, rechargeable batteries (in home appliances) should be removed from the device before disposing.
- Batteries may also be disposed of at a recycling box at a store.
- Batteries from automobiles and motorcycles cannot be disposed of.



Do not put into the "Non-Burnable Trash" bag!!



Dispose of them as "Hazardous Waste."

Examples of hazardous wastes with non-removable rechargeable batteries



*Batteries can be disposed at a small home appliance recycling collection box.

Follow the rules for using a garbage station and cooperate actively with the district officers and duty persons.

[Main functions]

- Garbage Separation Dictionary: Instructions for separating garbage and notes
- How to trash garbage: How to trash various types of garbage
- Calendar: Collection days for various types of garbage
- Alert setting: Notification of collection days
- Notice from Ota City and FAQ (Q&A format)

Garbage Separation App

Download here! ▶



ios端末用



Android端末用

You can view the "Instructions for separating and trashing household garbage" and the "Collection calendar" in five foreign languages.

FAQ (Q&A) [Extra edition] regarding separation and collection

- Q A warning sticker is attached, or garbage is not collected.
- A For enforcing the garbage separation rules, a warning sticker (red or orange) is attached to the violation garbage, and it will not be collected. Please re-sort your garbage correctly and put it out again on the next collection day. If your garbage is not collected even after the evening, please check the collection day. *Garbage placed after the collection day will not be collected. *Please pick it up and put it again on the next collection day.
- Q Want to come earlier for collection or collect at a specific time.
- A The garbage is collected along a fixed route, but for sufficient collection, collection times and routes may be changed depending on the amount of garbage on that day, traffic conditions, weather, and other factors. Please make sure to put your garbage at the designated garbage station by 8:30 a.m. on the collection day.
- Q Garbage at the garbage station is littered up by crows.
- A The garbage station is set up and managed by local officers and users (administrators) based on the setup conditions of Ota City. We ask all users of the station for managing cooperatively it through cleaning. For stations managed by the district, we provide anti-crow nets, so please consult with a district officer. Note: For apartments and other housing complexes, please consult with the manager.

[Extra edition] Examples and reasons of oversized garbage unacceptable at the garbage station

- Dehumidifiers: More "CFC type dehumidifiers (refrigerant type)" that are unacceptable by the city are trashed at the garbage station. *Refrigerant type should be handled by a specialized company.
- Printers: Due to more printers whose toners are not removed and hazardous laser ink-type printers that can cause fire, we ask for door-to-door collection or taking them to a facility for safety during collection operations or at the receiving facility.
- Beanbags and duvets: We ask for door-to-door collection or taking them to a facility because their contents are scattered on the street and inside the garbage truck.

Diversified products in recent years have caused more cases of confusion regarding the classification of bulky waste and how to trash them at the garbage station. We would like to ask for your continued cooperation in using the "How to Separate and Trashing Garbage" leaflet to ensure correct separation and safe and prompt collection.